

GM-W

MALE GLAND

Without shoulder

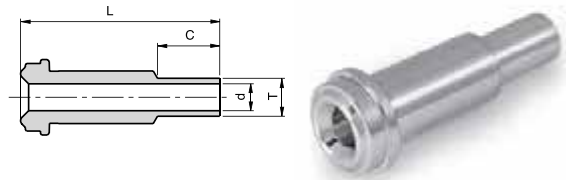

Ordering Information	Face Seal size	L		C		d		T
	inch	mm	inch	mm	inch	mm	inch	Tube O.D inch
V-GM-1/8-W	1/8	17.8	0.70	7.1	0.28	1.9	0.07	1/8
V-GM-1/4-W	1/4	33.3	1.31	10.4	0.41	3.0	0.12	1/4
V-GM-3/8-W	1/2	38.1	1.50	10.4	0.41	7.1	0.28	3/8
V-GM-1/2-W	1/2	38.1	1.50	12.7	0.50	10.2	0.40	1/2
P-GM-3/4-W	3/4	50.8	2.00	15.7	0.62	13.5	0.53	3/4
P-GM-1-W	1	56.4	2.22	20.6	0.81	19.1	0.75	1

GS-W

SHORT GLAND

Without shoulder

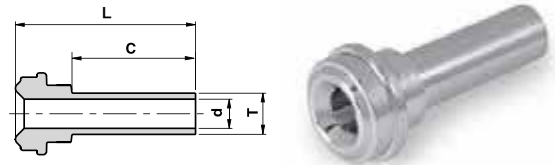

Ordering Information	Face Seal Size	L		C		d		T	W.T.	
	inch	mm	inch	mm	inch	mm	inch	inch / mm	mm	inch
V-GS-1/8-W	1/8	27.4	1.08	19.1	0.75	1.9	0.07	1/8"	-	0.028
V-GS-1/4-W	1/4	27.9	1.10	19.1	0.75	4.6	0.18	1/4"	-	0.035
V-GS-1/4 X 1/8 -W	1/4	27.9	1.10	19.1	0.75	1.9	0.07	1/8"	-	0.028
V-GS -1/4-W 0.72	1/4	18.3	0.72	9.6	0.38	4.6	0.18	1/4"	-	0.035
V-GS-3/8-W	1/2	28.4	1.12	19.1	0.75	7.7	0.30	3/8"	-	0.035
V-GS-1/2-W	1/2	28.4	1.12	19.1	0.75	10.2	0.40	1/2"	-	0.049
V-GS-1/2-W W.T.=0.065	1/2	28.4	1.12	19.1	0.75	9.5	0.37	1/2"	-	0.065
V-GS-1/2-W-0.74	1/2	18.8	0.74	9.7	0.38	10.2	0.40	1/2"	-	0.049
V-GS-1/2 X 1/4-W	1/2	28.4	1.12	19.1	0.75	4.6	0.18	1/4"	-	0.035
P-GS-3/4-W W.T.=0.049	3/4	29.0	1.14	19.1	0.75	16.6	0.65	3/4"	-	0.049
P-GS-3/4-W W.T.=0.065	3/4	29.0	1.14	19.1	0.75	15.8	0.62	3/4"	-	0.065
P-GS-1-W W.T.=0.065	1	32.0	1.26	19.1	0.75	22.1	0.87	1"	-	0.065
V-GS-6MM-W	1/4	29.4	1.16	19.1	0.75	4.0	0.16	6mm	1.00	-
V-GS-8MM-W	1/4	29.5	1.16	19.1	0.75	6.0	0.24	8mm	1.00	-
V-GS-10MM-W	1/2	29.4	1.16	19.1	0.75	8.0	0.31	10mm	1.00	-
V-GS-12MM-W	1/2	29.4	1.16	19.1	0.75	10.0	0.39	12mm	1.00	-
P-GS-18MM-W	3/4	31.0	1.22	19.1	0.75	15.0	0.59	18mm	1.50	-

Dimensions are for reference only, and are subject to change without notice.
When ordering, be sure to add the Surface-Finish Designator (either H or E) to the Part Number. (See Material Table, page 157).